

GTDU - U-BOLT GROUNDING CLAMP (1 CONDUCTOR)

GTDU-1.1/2"-IPS-2/0-250

Description

**Purpose:** Connection between ground rod to cable or IPS tube-cable. Suitable for COPPERSTEEL or copper cables.

**Characteristics:** Tightening connection. High electrical conductivity and corrosion resistant. It allows you to connect a cable, at 90º in relation to the rod / IPS tube.

**Application:** Grounding systems in general (power distribution systems, grounding grids, residential, building and industrial grounding, grounding in telecommunication networks, grounding in substations).

**Material:** Copper alloy clamp, fittings in copper alloy or electrolytic zinc plated steel.

**Application Tool:** Spanner set or open-ended wrench.

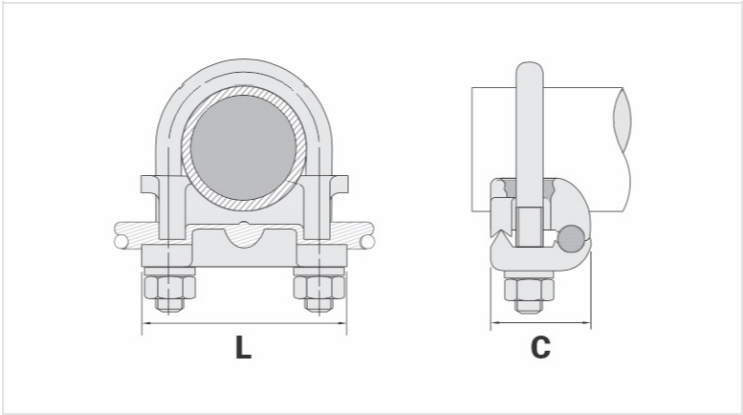

Datasheet

Conductor		
AWG/MCM		2/0 - 250
mm²		70 - 120
Ground Rod Nominal Diameter (inches)		
		-
IPS Tube		
		1.1/2"
Accessory Material		Liga de Cobre
Dimensions		
L		82,0
A		
C		45,0
Parafuso "U"		M10
Figura		1
Package		
Qtd / Emb		10
Peso Unit. (g)		590,00