

GTDU - U-BOLT GROUNDING CLAMP (1 CONDUCTOR)

GTDU-2.1/2"-IPS-2/0-250

Description

Purpose: Connection between ground rod to cable or IPS tube-cable. Suitable for COPPERSTEEL or copper cables.

Characteristics: Tightening connection. High electrical conductivity and corrosion resistant. It allows you to connect a cable, at 90º in relation to the rod / IPS tube.

Application: Grounding systems in general (power distribution systems, grounding grids, residential, building and industrial grounding, grounding in telecommunication networks, grounding in substations).

Material: Copper alloy clamp, fittings in copper alloy or electrolytic zinc plated steel.

Application Tool: Spanner set or open-ended wrench.

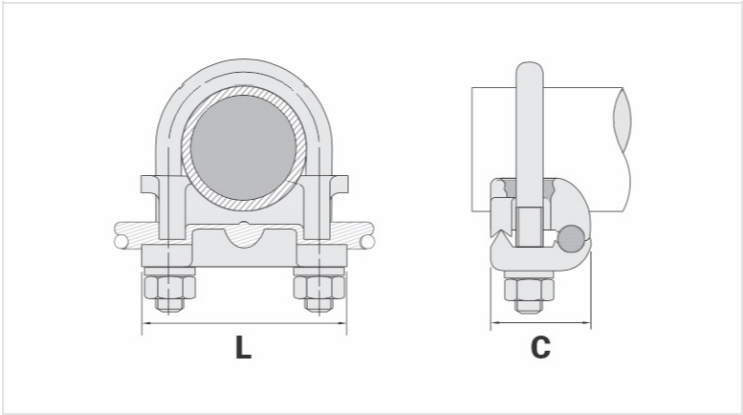

Datasheet

| | | |
|--------------------------------------|--|---------------|
| Conductor | | |
| AWG/MCM | | 2/0 - 250 |
| mm² | | 70 - 120 |
| Ground Rod Nominal Diameter (inches) | | |
| | | - |
| IPS Tube | | |
| | | 2.1/2" |
| Accessory Material | | Liga de Cobre |
| Dimensions | | |
| L | | 111,0 |
| A | | |
| C | | 48,0 |
| Parafuso "U" | | M10 |
| Figura | | 1 |
| Package | | |
| Qtd / Emb | | 10 |
| Peso Unit. (g) | | 795,80 |