

GTDU - U-BOLT GROUNDING CLAMP (1 CONDUCTOR)

GTDU 1/2"-3/4" IPS 8-4

Description

- Purpose:** Connection between ground rod to cable or IPS tube-cable. Suitable for COPPERSTEEL or copper cables.
- Characteristics:** Tightening connection. High electrical conductivity and corrosion resistant. It allows you to connect a cable, at 90º in relation to the rod / IPS tube.
- Application:** Grounding systems in general (power distribution systems, grounding grids, residential, building and industrial grounding, grounding in telecommunication networks, grounding in substations).
- Material:** Copper alloy clamp, fittings in copper alloy or electrolytic zinc plated steel.
- Application Tool:** Spanner set or open-ended wrench.

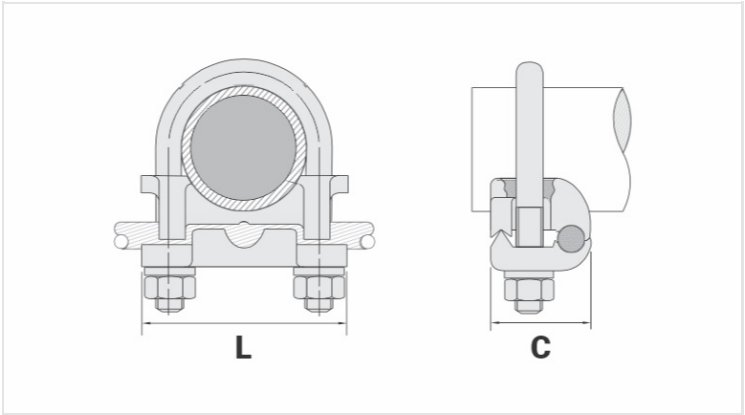

Datasheet

Conductor

AWG/MCM	8 - 4
mm²	10 - 25

Ground Rod Nominal Diameter (inches)	7/8" - 1"
--------------------------------------	-----------

IPS Tube	1/2" - 3/4"
----------	-------------

Accessory Material

Dimensions

L	59,0
A	
C	41,0
Parafuso "U"	M10
Figura	1

Package

Qtd / Emb
Peso Unit. (g)