

GTDU - U-BOLT GROUNDING CLAMP (1 CONDUCTOR)

GTDU 1" IPS 300-500

Description

Purpose: Connection between ground rod to cable or IPS tube-cable. Suitable for COPPERSTEEL or copper cables.

Characteristics: Tightening connection. High electrical conductivity and corrosion resistant. It allows you to connect a cable, at 90º in relation to the rod / IPS tube.

Application: Grounding systems in general (power distribution systems, grounding grids, residential, building and industrial grounding, grounding in telecommunication networks, grounding in substations).

Material: Copper alloy clamp, fittings in copper alloy or electrolytic zinc plated steel.

Application Tool: Spanner set or open-ended wrench.

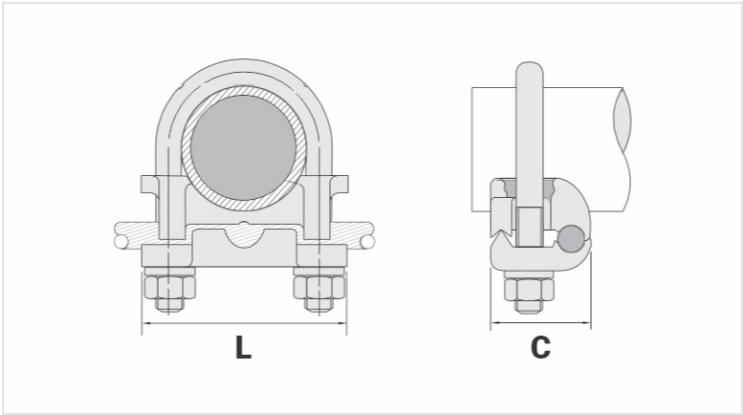

Datasheet

Conductor		
AWG/MCM		300 - 500
mm²		150 - 240
Ground Rod Nominal Diameter (inches)		
		-
IPS Tube		
		1"
Accessory Material		
Dimensions		
L		76,0
A		
C		61,0
Parafuso "U"		M12
Figura		1
Package		
Qtd / Emb		
Peso Unit. (g)		