

CCA - WEDGE TYPE CONNECTOR FOR GROUNDING

CCA-12-25

Description

- Purpose:** Connection between ground rod to cable. Suitable for COPPERSTEELor copper cables.
- Characteristics:** Spring system connection (permanent tightening). High resistance to corrosion. Easy application. Supplied with antioxidant compound INTELTRON-Cu.
- Application:** Grounding systems in general (power distribution systems, grounding grids, residential, building and industrial grounding), grounding in telecommunication networks).
- Material:** Copper Alloy.
- Finish:** Tin plated Application Tool: Water pump pliers.

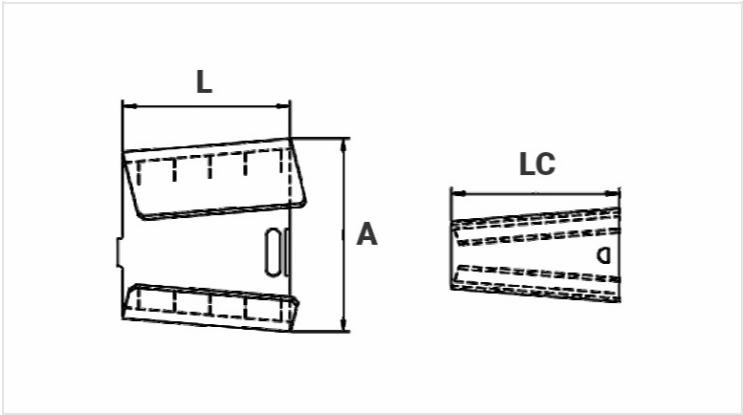

Datasheet

Conductor		
AWG/MCM		8 - 4
mm²		10 - 25
Ground Rod Diameter		1/2" (12,7mm)
Dimensions		
L		31,7
A		37,9
LC		31,7
Package		
Qtd / Emb		50
Peso Unit. (g)		58,00