

**SACC - CABLE TO CABLE COMPRESSION GROUNDING SYSTEM**

SACC-120-120

**Description**

**Purpose:** Cable to cable splice or branch. Suitable for COPPERSTEEL and copper cables.

**Characteristics:** Compression connection. High resistance to corrosion. It can be buried directly into the ground or concrete.

**Application:** Grounding systems in general (power distribution systems, grounding grids, residential, building and industrial grounding), grounding in telecommunication networks, grounding in substations).

**Material:** Copper alloy, supplied with antioxidant compound INTELTROX-Cu.

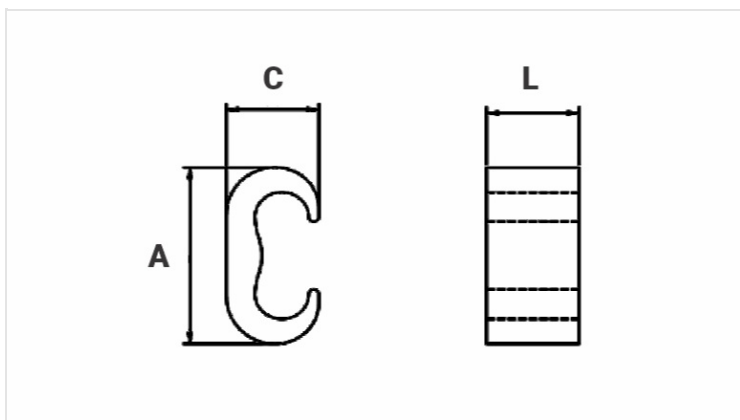

**Datasheet**

**Conductor**

Principal

AWG/MCM

3/0 - 250

mm<sup>2</sup>

95 - 120

Derivação

AWG/MCM

3/0 - 250

mm<sup>2</sup>

95 - 120

**Die Index**

IU-997

**Application Tool**

AY-96/CY-96

**Compressions**

1

**Dimensions (mm)**

L

22,0

A

49,0

C

24,0

**Package**

Qtd / Emb

25

Peso Unit. (g)

92,00