

TM-2 - COPPER COMPRESSION TERMINAL (TWO HOLES / SHORT BARREL)

TM-500-2

Description

Purpose: Termination of copper conductors.

Characteristics: High electrical conductivity and corrosion resistance. Pad with several hole diameter options and optimum electrical contact.

Applications: Electrical panels, circuit breaker connections, motors, machines, busbars, electrical distribution boards, among others.

Material: Electrolytic copper.

Finish: Tin plated.

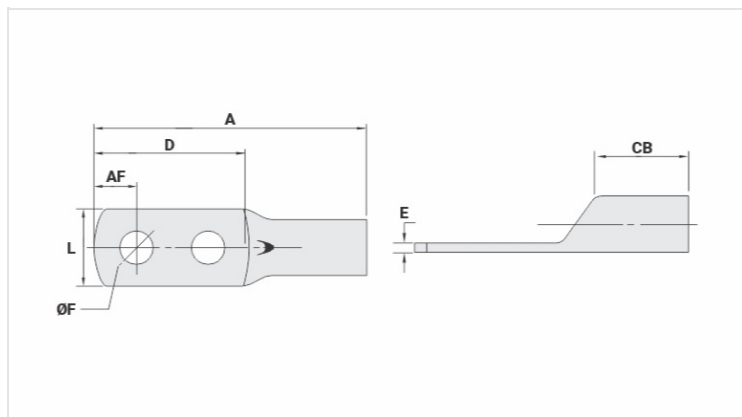

Datasheet

Conductors - Cross Section (mm²) 500

Dimensions (mm)

Diâmetro do Furo (mm) 13,8

Parafuso*

Pol. 1/2

Métrico M12

L 52,0

A 154,0

CB 44,0

AF 19,0

D 86,4

E 5,1

Current (A) 1253

Application Tool

Alicates Mecânico

Modelo -

Matriz (AT-60) -

Alicates Hidráulico (AY-96 / CY-96)

Matriz Circunf. IU-44

Matriz Hexagonal H-44

Package

Qtd / Emb

10

Peso Unit. (g)

340,00