

MAT/FET - MALE/FEMALE QUICK DISCONNECT TYPE TERMINALS WITH TOTAL INSULATION

FET-1,5-6

Description

Purpose: Connection / disconnection of rigid or flexible copper cables.

Characteristics: Compression connection. High electrical conductivity and corrosion resistance.

Application: Electrical installations in general (residential, building, industrial).Circuits up to 90°C and 750V.

Material: Electrolytic copper and polypropylene insulation.

Finish: Tin plated and insulated.

Application Tool: AT-10 or ATC-6.

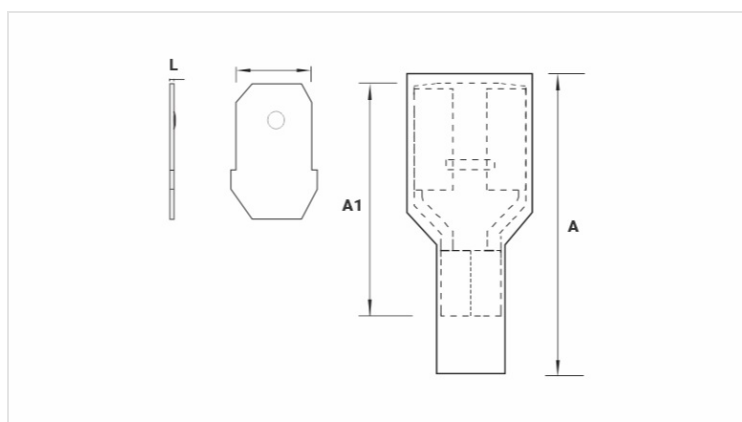
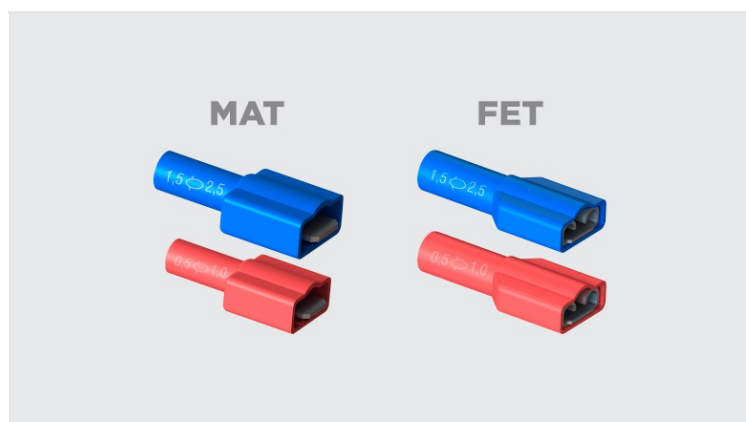

Datasheet

Insulation per DIN Standard (Color)	VERMELHO
Conductor	
AWG/MCM	22 - 18
mm ²	0,5 - 1,0
Dimensions (mm)	
L	6,4
A	24,0
C	
E	0,8
A1	18,5
Maximum Current (A)	10
Package	
Qtd / Emb	100
Peso Unit. (g)	1,15