

TID - DOBLE EYELET TYPE PRE-INSULATED TERMINALS

TID-1,5-8

Description

Purpose: Termination of rigid or flexible copper cables for terminal blocks. Recommended for application of two conductors.

Characteristics: Compression connection. High electrical conductivity and corrosion resistance.

Application: Electrical installations in general (residential, building, industrial). Circuits up to 105°C and 750V.

Material: Electrolytic copper and nylon insulation.

Finish: Tin plated and insulated.

Application Tool: ATIC-6 (TID-0,5 to TID-4) or ATIC-35 (TID-6 to TID-16).

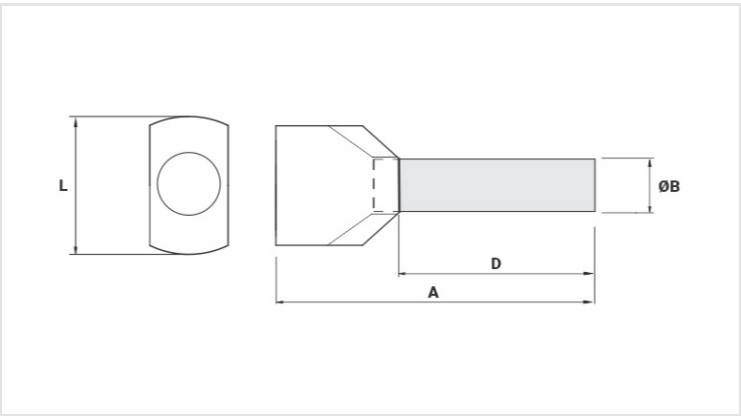
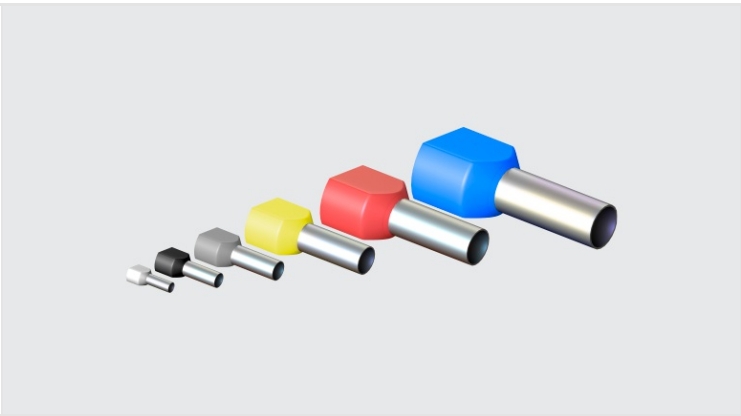

Datasheet

Insulation per DIN Standard (Color)	PRETO
Conductor	
AWG/MCM	2x 16
mm²	2x 1,5
Dimensions (mm)	
L	7,2
A	15,5
C	
Ø B	2,6
D	8,0
Maximum Current (A)	18
Package	
Qtd / Emb	100
Peso Unit. (g)	0,20