

TID - DOBLE EYELET TYPE PRE-INSULATED TERMINALS

TID-2,5-10

Description

- Purpose:** Termination of rigid or flexible copper cables for terminal blocks. Recommended for application of two conductors.
- Characteristics:** Compression connection. High electrical conductivity and corrosion resistance.
- Application:** Electrical installations in general (residential, building, industrial). Circuits up to 105°C and 750V.
- Material:** Electrolytic copper and nylon insulation.
- Finish:** Tin plated and insulated.
- Application Tool:** ATIC-6 (TID-0,5 to TID-4) or ATIC-35 (TID-6 to TID-16).

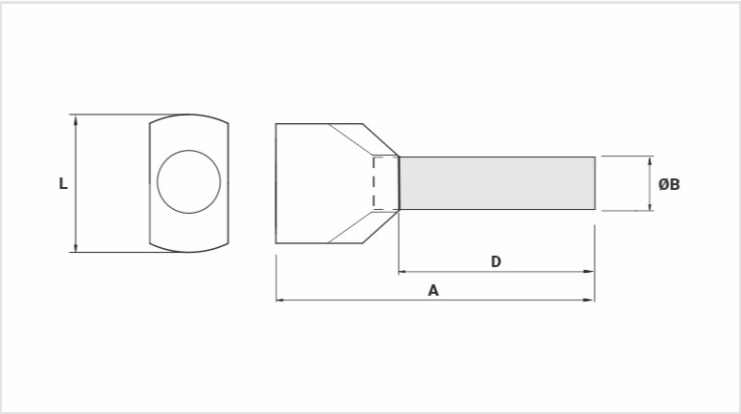
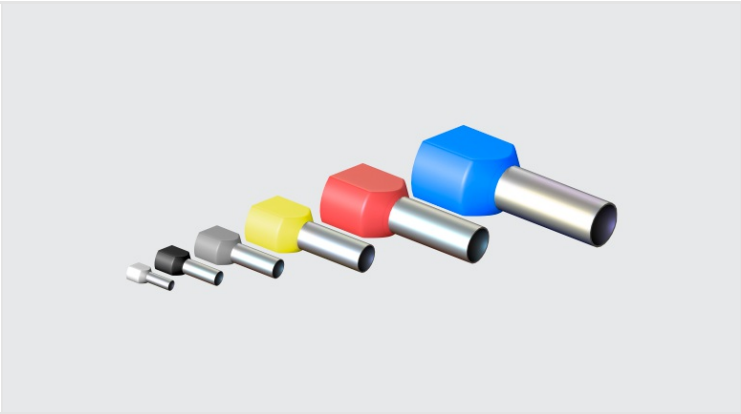

Datasheet

| | | |
|-------------------------------------|--|--------|
| Insulation per DIN Standard (Color) | | AZUL |
| Conductor | | |
| AWG/MCM | | 2x 14 |
| mm² | | 2x 2,5 |
| Dimensions (mm) | | |
| L | | 9,0 |
| A | | 18,5 |
| C | | |
| Ø B | | 3,3 |
| D | | 10,0 |
| Maximum Current (A) | | 30 |
| Package | | |
| Qtd / Emb | | 100 |
| Peso Unit. (g) | | 0,35 |