

TID - DOBLE EYELET TYPE PRE-INSULATED TERMINALS

TID-4-12

Description

**Purpose:** Termination of rigid or flexible copper cables for terminal blocks. Recommended for application of two conductors.

**Characteristics:** Compression connection. High electrical conductivity and corrosion resistance.

**Application:** Electrical installations in general (residential, building, industrial). Circuits up to 105°C and 750V.

**Material:** Electrolytic copper and nylon insulation.

**Finish:** Tin plated and insulated.

**Application Tool:** ATIC-6 (TID-0,5 to TID-4) or ATIC-35 (TID-6 to TID-16).

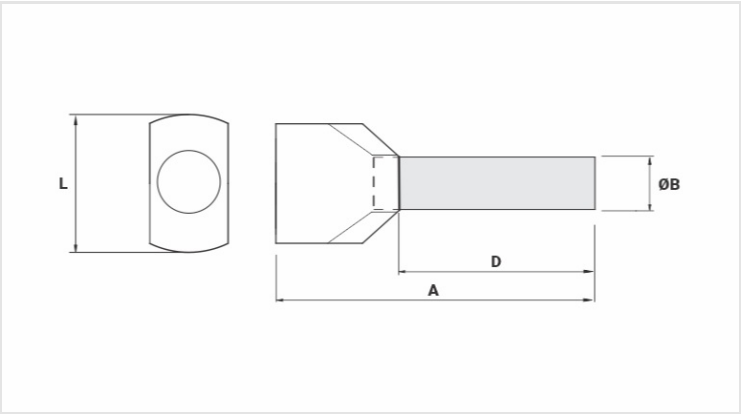
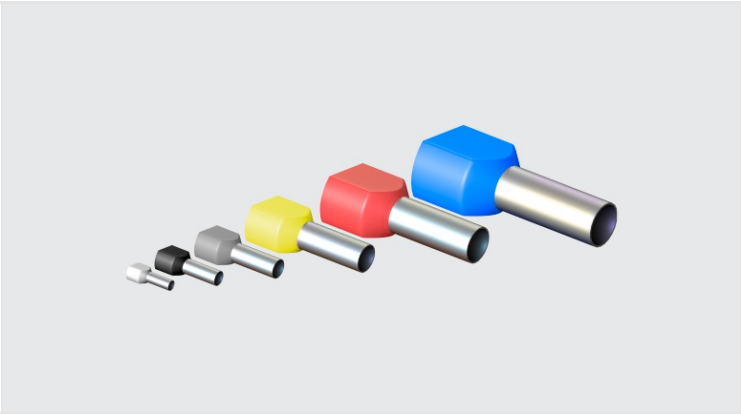

Datasheet

Insulation per DIN Standard (Color)	CINZA
Conductor	
AWG/MCM	2x 12
mm²	2x 4
Dimensions (mm)	
L	9,3
A	23,1
C	
Ø B	4,2
D	12,0
Maximum Current (A)	35
Package	
Qtd / Emb	100
Peso Unit. (g)	0,51