

**CADC - ALUMINUM WEDGE TYPE CONNECTOR**

CADC-102

**Description**

**Purpose:** CA or CAA aluminum and copper cables tap. Suitable for aluminum-aluminum and aluminum-copper connections.

**Characteristics:** Spring system connection (permanent tightening). High electrical conductivity and corrosion resistance.

**Application:** Power distribution lines.

**Material:** Aluminum alloy body and wedge. Supplied with antioxidant compound INTELTROX.

**Application Tool:** Impact tool with cartridge for wedge connector.

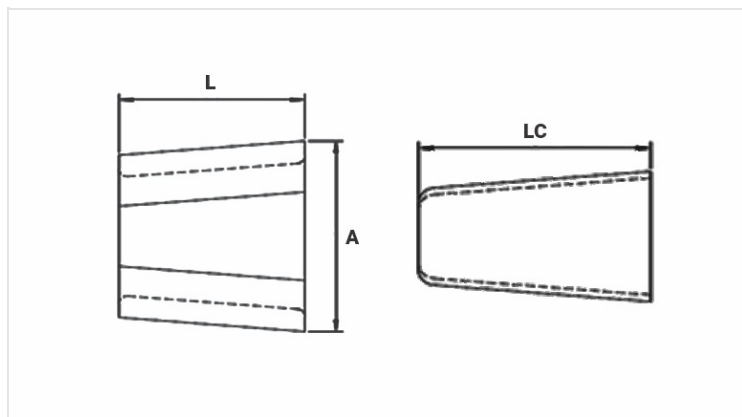

**Datasheet**

**Application Cartridge Color** VERMELHO

**Conductors**

Principal

Min. (mm) 6,53

Máx. (mm) 10,11

AWG/MCM 2 | 1/0

Derivação

Min. (mm) 4,11

Máx. (mm) 6,55

AWG/MCM 4 | 6

Soma dos Condutores

Min. (mm) 11,79

Máx. (mm) 15,29

**Dimensions (mm)**

L 31,7

A 39,5

LC 38,0

**Package**

Qtd / Emb 50

Peso Unit. (g) 39,60

