

CAEP - ALUMINUM WEDGE TYPE CONNECTOR WITH STIRRUP (PROTECTED LINE MODEL)

CAEP-103

Description

Purpose: Connection with copper, aluminum CA and CAA cables. Enables ing of a hotline clamp in 15kV protected networks.

Characteristics: Spring system connection (permanent tightening). High electrical conductivity and corrosion resistance.

Application: Power distribution lines.

Material: Aluminum alloy body and wedge and stirrup in electrolytic copper. Supplied with antioxide compound INTELTROX.

Finishing (Stirrup): Tin plated.

Application Tool: Impact tool with cartridge for wedge connector.

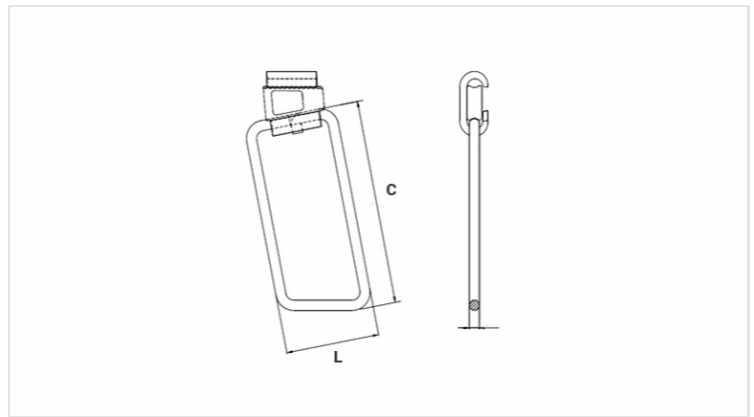

Datasheet

| | |
|------------------------------------|----------|
| Application Cartridge Color | VERMELHO |
| Conductors | |
| AWG/MCM | 4 - 2 |
| Tipo do Condutor | CA/CAA |
| Stirrup (AWG) | 2 |
| Dimensions (mm) | |
| L | 60,0 |
| C | 140,0 |
| Ø C | 6,5 |
| Package | |
| Qtd / Emb | 30 |
| Peso Unit. (g) | 151,40 |