

**CAEP - ALUMINUM WEDGE TYPE CONNECTOR WITH STIRRUP (PROTECTED LINE MODEL)**

CAEP-105

**Description**

**Purpose:** Connection with copper, aluminum CA and CAA cables. Enables ing of a hotline clamp in 15kV protected networks.

**Characteristics:** Spring system connection (permanent tightening). High electrical conductivity and corrosion resistance.

**Application:** Power distribution lines.

**Material:** Aluminum alloy body and wedge and stirrup in electrolytic copper. Supplied with antioxide compound INTELTROX.

**Finishing (Stirrup):** Tin plated.

**Application Tool:** Impact tool with cartridge for wedge connector.

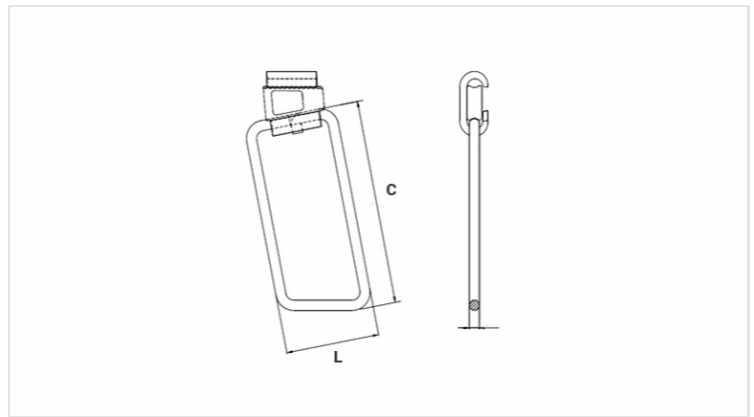

**Datasheet**

<b>Application Cartridge Color</b>	VERMELHO
<b>Conductors</b>	
AWG/MCM	8 - 6
Tipo do Condutor	CA/CAA
<b>Stirrup (AWG)</b>	2
<b>Dimensions (mm)</b>	
L	60,0
C	140,0
Ø C	6,5
<b>Package</b>	
Qtd / Emb	30
Peso Unit. (g)	151,00