

LCBF - CAST ALUMINUM COMPRESSION CONNECTOR WITH STIRRUP

LCBF-38

Description

Purpose: Connection with CA, CAA aluminum cables. Enables ing of a hotline clamp oring of up to four wedge type or compression connectors.

Characteristics: Compression connection. High electrical conductivity and corrosion resistance.

Application: Power distribution lines.

Material: Cast aluminum body and stirrup in electrolytic copper. Supplied with antioxidant compound INTELTROX.

Finishing (Stirrup): Tin plated.

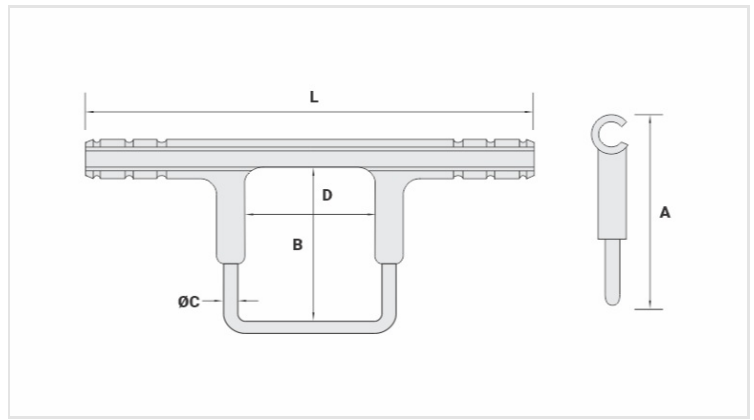

Datasheet

Conductors

CA/CAA 4 - 2

Dimensions (mm)

L 230,0

A 90,0

B 64,0

D 64,0

Ø E 6,3

Application Tool

AT-60

Matriz IW-BG

Compressões 3

AY-96 / CY-96

Matriz IU-BG

Compressões 3

Package

Qtd / Emb 50

Peso Unit. (g) 180,00