

LCBF - CAST ALUMINUM COMPRESSION CONNECTOR WITH STIRRUP

LCBF-44

Description

Purpose: Connection with CA, CAA aluminum cables. Enables ing of a hotline clamp oring of up to four wedge type or compression connectors.

Characteristics: Compression connection. High electrical conductivity and corrosion resistance.

Application: Power distribution lines.

Material: Cast aluminum body and stirrup in electrolytic copper. Supplied with antioxidant compound INTELTROX.

Finishing (Stirrup): Tin plated.

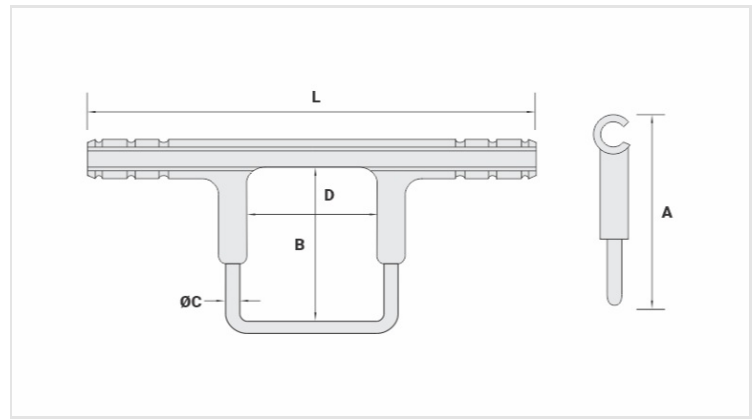

Datasheet

Conductors

CA/CAA	1/0
--------	-----

Dimensions (mm)

L	248,0
A	113,0
B	89,0
D	64,0
Ø E	6,3

Application Tool

AT-60	
Matriz	IW-C
Compressões	4
AY-96 / CY-96	
Matriz	IU-C
Compressões	2

Package

Qtd / Emb	25
Peso Unit. (g)	236,20